

B-Speech[®]
sora

User Manual
Benutzerhandbuch
Manuel d'utilisation
Modo de uso



FCC Information

This device complies with Part 15 of the FCC rules.

Operation is subject to the following two conditions: (1) this device may not cause harmful interference, and (2) this device must accept any interference received; including interference that may cause undesired operation.

Federal Communications Commission (FCC) Statement

This Equipment has been tested and found to comply with the limits for a Class B digital device, pursuant to Part 15 of the FCC rules. These limits are designed to provide reasonable protection against harmful interference in a residential installation. This equipment generates, uses and can radiate radio frequency energy and, if not installed and used in accordance with the instructions, may cause harmful interference to radio communications. However, there is no guarantee that interference will not occur in a particular installation. If this equipment does cause harmful interference to radio or television reception, which can be determined by turning the equipment off and on, the user is encouraged to try to correct the interference by one or more of the following measures:

- Reorient or relocate the receiving antenna.
- Increase the separation between the equipment and receiver.
- Connect the equipment into an outlet on a circuit different from that to which the receiver is connected.
- Consult the dealer or an experienced radio/TV technician for help.

Warning:

Changes or modifications to this unit not expressly approved by the party responsible for compliance could void the user authority to operate the equipment.

Tested to comply with FCC standard.
FOR HOME OR OFFICE USE.

Warning :

This equipment complies with FCC RF radiation exposure limits set forth for an uncontrolled environment. & This device and its antenna(s) must not be co-located or conjunction with any other antenna or transmitter.

Congratulations

Congratulations on your purchase of the B-Speech® SORA multilink-headset. This headset allows you to communicate wirelessly through your mobile phone and includes a built-in microphone and earphone. It uses BT 2.1 and multilink technology, but is also compatible with mobile phones using version 1.1 technology. Your B-Speech® SORA headset uses a built-in Lithium Polymer rechargeable battery, with long life.

Package Contents

- Headset B-Speech® SORA
- 2 Ear hook
- 3 Rubber ear gels
- USB Charger Cable or Optional AC adaptor
- User Guide

Headset overview

1. Earhook
2. Volume -
3. Volume +
4. Earphone
5. Microphone

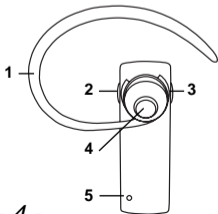

- 6. Multifunction key
- 7. Status LED
- 8. Earhook hinge
- 9. Charging port

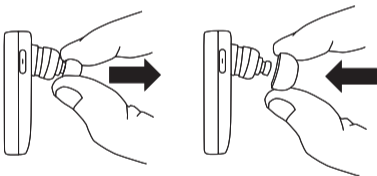
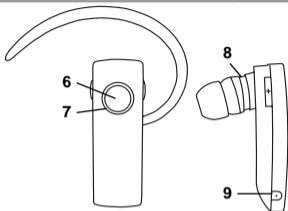

The headset can be worn on either ear. Just clip the ear hook on to the preferred side.



Charging the internal battery

Before using your headset, please charge the internal battery. To charge the battery:

1. Connect the USB Charger to a USB port.
2. Plug the adaptor's connector into the charging port of SORA
3. While charging, the red LED light will stay on and turn off when charging is complete. You can then unplug the adaptor's connector from the headset and disconnect the adaptor from the electrical outlet.
4. During normal use you see the red LED blinking, please charge the Headset
5. Charging time is about 2 hours

Switching the headset on or off

To switch on:

Press and hold the multi-function key for 3 seconds until the blue LED comes on.

To switch off:

Press and hold the multi-function key for 3 seconds until the red LED flashes.

Note, if there is no connection with B-Speech® SORA, the headset will switch off automatically.
After switching on , Sora will go into auto-pairing mode and connect to the mobiles, which were paired before

Pairing Procedure

Your B-Speech® SORA needs to be paired to your Bluetooth® mobile phone before it can be used. This is a two part process; one part is carried out on the headset and the other is carried out on the mobile phone.

Note that different mobile phones use different methods of pairing.

To pair your B-Speech SORA:

1. With your head set turned off, press and hold the multi-function key for 7 sec. The LED will alternate rapidly between blue and red which indicates that the head set is in pairing mode.
2. Use your phone's menu to search for Bluetooth® audio devices. The phone should indicate it has found the B-Speech® SORA headset. Confirm that you want to pair your mobile phone and headset together. If you are unsure how to go through the pairing process on your mobile phone, please refer to the user manual.

3. When asked for a pin key, enter: "0000". Your phone will confirm that pairing has been successful.

***Note** that there is usually a time limit to pair devices,*

Note for Multi-link use:

In order to pair a second mobile please press the volume - button for 3 seconds, the LED will alternate rapidly between blue and red, B-Speech® SORA will go into pairing Mode and you can pair the second mobile. Please proceed with pairing as described before.

To activate the Multi-link-function please press volume +/- at the same time for 3 seconds. B-Speech SORA will get into the multilink Mode, the Blue LED will blink twice.

Phone call use

Making a call from the mobile phone

While your mobile phone is paired with your headset, you can use the mobile phone to make phone calls in the same way as normal. The only difference will be that the earphone and microphone functions of the head set will be used instead of the phone's.

Answering a call

to answer a call after a ring tone heard in your headset,

simply press the multi-function key.

Note that you can set your mobile phone to automatically answer calls, which means you do not even need to press the multi-function key. Please refer to your mobile phone's user guide for more information about this setting.

Note for Multi-link use: You must end the first call before you can receive the incoming call of the second mobile (to be automatically re-paired with the second mobile takes 6 -7 seconds) then you will hear the phone ring tone in your headset and if you now press the multi-function key you can receive the call of the second mobile.

While answering a phone call in the multi-link function, the BT link with the other mobiles will be interrupted.

Ending a call

During a call, press the multi-function key to hang up. If the other person hangs up first, then the call will end automatically.

Voice dialling through the headset

In order to use the voice dial feature of your headset, your phone must support voice dialling and must have voice tags stored. To use voice dialling, the corresponding voice profiles must be stored I your Phone Your Mobile must also sup-

port this function. Press the multi-function key briefly. You will hear a short tone. Speak the voice tag immediately. Your phone will make the call.

Last number redial

When the headset is in standby mode (not in conversation), press the volume + key 3 seconds, (tone appear) and your phone will re-dial the last number that you called.

***Note:** This function only works on Bluetooth® phones that support the Hands-free profile In the multi-link mode, the number is either the number of the last paired or the last used mobile.*

Transferring a single call

When activating a call, you can press the Multifunction key for 3 seconds (a tone appear) to switch the conversation between the headset and the mobile phone. Press the talk key shortly to return to Headset.

Rejecting Calls

Press the multi-function key for 3 seconds during an incoming phone (a tone will be heard) call to reject the call.

Microphone Mute

While talking using the headset press and hold the volume +/-

for 3 seconds to mute the microphone.
Press shortly the volume -/+ to activate the head set microphone.

Adjusting the volume

- To increase the volume, briefly press the increase volume key.
- To decrease the volume, briefly press the decrease volume key.

Bluetooth® headset specification

- BT Version 2.1 Class 2
- Maximum distance 30 Feet (10 meters)
- Multilink, 2 mobile phones can be used simultaneously
- Typical standby time is up to 100 hours
- Typical talk time is up to 7 hours
- Typical re-charge time is 2 hours
- Battery type: Lithium Polymer rechargeable

Registration and Safety

Certification/General Information

This device bears the CE symbol as specified by the provisions of Directive R & TTE (99/5/EC). B-Speech hereby declares that this device is in compliance with the basic requirements and other relevant guidelines and regulations

of the 1999/5/EC guideline.

You will find the declaration of conformity on the Internet at <http://www.b-speech.com>.

Note on environmental protection:

After the implementation of the European Directive 2002/96/ EU in the national legal system, the following applies: Electrical and electronic devices may not be disposed of with domestic waste. Consumers are obliged by law to return electrical and electronic devices



at the end of their service lives to the public collecting points set up for this purpose or point of sale. Details of this are defined by the national law of the respective country.

This symbol on the product, the instruction manual or the package indicates that a product is subject to these regulations. By recycling, re-using the materials or other forms of utilising old devices, you are making an important contribution to protecting our environment.

The Bluetooth word mark and logos are owned by the Bluetooth SIG, Inc.
and any use of such marks by D-Parts is under license.
Other trademarks and trade names are those of their respective owners.